

MARTIN™ SD89, SD910, and SD1011

SPECIFICATIONS:

SD89

30 yds. WF8F plus 150 yds. of 20# backing capacity

7.75 oz. Weight

3 1/2" Diameter; 1 5/16" Spool Depth

SD910

30 yds. WF9F plus 220 yds. of 20# backing capacity

8.0 oz. Weight

3 1/2" Diameter; 1 1/8" Spool Depth

SD1011

30 yds. WF10F plus 220 yds. of 30# backing capacity

10.0 oz. Weight

3 1/2" Diameter; 1 3/8" Spool Depth

FEATURES:

Single action

High-strength, lightweight aluminum alloy frame

Counterbalanced rim-control spool

Exclusive 360° floating disc drag system

Sculptured crank handles

Machined, replaceable reel foot

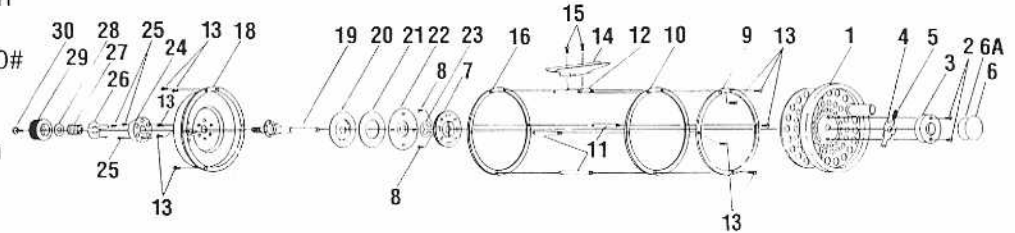

Key No.	SD89 Part No.	SD910 Part No.	SD1011 Part No.	Description	Price
1	F54	N/A	N/A	Spool Assembly	25.50
1	N/A	F55	N/A	Spool Assembly	26.50
1	N/A	N/A	F56	Spool Assembly	27.50
2	RR130-10A	RR130-10A	RR130-10A	Spool Lock Cap Screw	.20
3	251X-MP	251X-MP	251X-MP	Spool Lock Cap	1.20
4	XM050-01A	XM050-01A	XM050-01A	Spool Lock	.80
5	253S	253S	253S	Spool Lock Spring	.32
6	727S	727S	727S	Medallion	1.03
6A	9501	9501	9501	Glue Circle	.93
7	1209PP	1209PP	1209PP	Clutch Assy	5.30
8	RR130-09A	RR130-09A	RR130-09A	Clutch Screw	.75
9	WC193-03ACP	WC193-03ACP	WC193-03ACP	Rim (Spool Side)	2.75
10	WC193-09ACP	WC193-09ACP	WC193-09ACP	Line Guide (Spool Side)	1.30
11	689-01A	805A-01A	612S-01A	Line Guide Posts	2.95
12	690-01A	803S-01B	618S-01B	Reel Foot Post	2.16
13	234	234	234	Pillar Screw	.32
14	809-01A	809B-01A	809B-01A	Reel Foot	5.57
15	RR130-10A	RR130-10A	RR130-10A	Reel Foot Screw	.20
16	M-781-01BCP	M-781-01BCP	M-781-01BCP	Line Guide (Back Side)	1.00
18	1383-SD89-01APD	1383-SD910-01APD	1383-SD101-01APD	Side Cover Assembly (Drag Side)	15.50
19	907-01A	N/A	N/A	Spindle	8.15
19	N/A	909-01B	N/A	Spindle	8.25
19	N/A	N/A	921-01A	Spindle	2.30
20	QC040-01A	QC040-01A	QC040-01A	Pressure Plate	1.85
21	RR111-10A	RR111-10A	RR111-10A	Teflon Brake Liner	.90
22	QC027-01A	QC027-01A	QC027-01A	Ratchet Friction Plate	3.45
23	RR190-04A	RR190-04A	RR190-04A	Retaining Ring	.60
24	360-01A	360-01A	360-01A	End Cap	3.25
25	RR130-04A	RR130-04A	RR130-04A	End Cap Screw	1.60
26	QC169-01A	QC169-01A	QC169-01A	Plunger Spring	5.00
27	QC108-02A	QC108-02A	QC108-02A	Drag Disc Spring	.80
28	532	532	532	Washer	.10
29	368-01A	368-01A	368-01A	Drag Nut	2.73
30	RR130-07A	RR130-07A	RR130-07A	Drag Knob (Spindle) Screw	1.00

MODEL INTRODUCED	EFFECTIVE DATE OF PARTS LIST/DIAGRAM	Oct. 1996	DISCONTINUED	N/A
------------------	--------------------------------------	-----------	--------------	-----

Prices subject to change without notice. Prices do not include postage and handling.

PLEASE ORDER BY PART NUMBER Zebco Division Brunswick Corporation, Box 270, Tulsa, OK 74101 USA 918-831-6965

